

Delivering  
**wireless**  
mobile imaging

DX-D 100<sup>+</sup> – Mobile DR from Agfa with wireless detector family

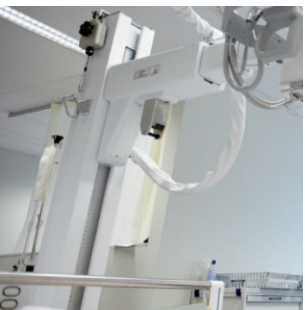

This brochure  
is enabled with  
Augmented Reality

# powerful

imaging on the move

In ICUs, emergency rooms and operating theaters, bedside examinations are an important part of the care process. Agfa's new DX-D 100<sup>+</sup> wireless mobile system can be easily moved and operated by a single person, and has a cable-free detector panel that reduces the risk of possible infection, facilitates faster patient handling and increases comfort of use for both patient and operator. The result is improved efficiency of bedside imaging and streamlined workflow through full integration with your RIS/PACS capabilities.

## Fully motorized, heavy duty solution

The compact, mobile DX-D 100<sup>+</sup> is a fully motorized, heavy duty solution designed to cope with challenging imaging tasks. Secondary controls on the system's arm allow positioning to be refined without returning to the main console. This enables operation by just one person and allows you to stay with your patient at all times.

## Wireless mobility for improved flexibility and infection control

The wireless capability of this mobile solution provides excellent flexibility, improving your overall workflow. In addition, the lack of trailing cable makes it a more hygienic solution, ideally suited for use in the ICU, pediatrics and neonatal areas.

## Batteries and configuration provide maximum power and autonomy

Lead crystal batteries are changing the possibilities of mobile imaging technology. Robust, resilient and performant, they offer 30% more autonomy, 30% more exposures, 30% more time before charging\*. The unique split battery set configuration further extends the autonomy, by taking the power needs of the motor and generator into account separately. This allows the DX-D 100<sup>+</sup> to capture, for example, up to 200 thorax examinations with one charge. The battery sets charge through a standard power socket, without special wiring, and the system can be used while charging, avoiding downtime.

## Powerful generator reduces exposure times and delivers sharper images

The DX-D 100<sup>+</sup> is equipped with X-ray generator power of up to 50 kw, making it ideal for imaging dense areas. The generator power rating is true, effective power – not a peak value. The high power results in shorter exposure times and less motion blur, for sharper abdomen and spine examinations and sharper images for bariatric patients.

## Ergonomic and maneuverable in restricted spaces

Requiring only light pressure to the drive handle to move it, the DX-D 100<sup>+</sup> is easily maneuvered to any location. Its small width makes it ideal for restricted spaces and corridors, while large wheels make mounting small steps easier.

## FreeView Technology

The FreeView technology gives you excellent manoeuvrability as you easily navigate busy corridors and rooms, with the telescopic arm and collapsible column offering you an unobstructed view. You can get to your patient swiftly and securely, while the easy-to-use system lets you quickly pop the column back up where you really need it: the patient's bedside.

\* Based on Agfa testing, actual results may vary.



Battery charger resulting in longer uptime, depending on detector type.



Secondary controls on the system's arm allow refinement of positioning without the need to return to the main console.



With the telescopic column your view is unobstructed, it provides you better maneuverability and allows you to get to your patient more quickly.



Enhanced convenience and hygiene, with 3 magnetic holders ideal for storing a packet of gloves and other supplies.



FreeView Technology



DX-D 100+: Wireless - Mobile - Maneuverable - Motorized

# instant

high quality image capture

The DX-D 100<sup>+</sup> uses the well-established and proven-NX acquisition workstation, with its fully integrated touch screen, for both image acquisition and interfacing with the generator. With the built-in MUSICA image processing, you enjoy the same look and feel for CR and DR, minimizing the need for user training. You'll also achieve fast image capture with an exposure monitoring functionality that results in better dose monitoring and control.

## High quality instant imaging

The DX-D 100<sup>+</sup> comes with a choice of Cesium Iodide (CsI) or Gadolinium Oxy-Sulphide (GOS) detector-technology. CsI delivers excellent image quality, fast image availability and the possibility for significant dose reduction. GOS provides a very cost-effective and excellent image quality. The system offers instant bedside imaging via portable wireless DR panels. The potential dose reduction offered by the DX-D 100<sup>+</sup> makes it ideal for patient groups such as pediatrics and neonatal.

## Consistent image quality with MUSICA

The DX-D 100<sup>+</sup> uses MUSICA image processing, offering excellent contrast detail with intelligent and automated digital radiography image processing, for consistently reliable, high quality image visualization. The MUSICA software automatically analyzes the characteristics of each image and optimizes the processing parameters – independent of user input and dose deviations. The result is minimal re- or post-processing and the potential for significant dose reduction.

## Fast image validation

Captured images can be validated quickly after exposure; should a retake be required, it can be made straightaway. With up to 4000 images stored on the DX-D 100<sup>+</sup> at any one time, comparison with prior images is quick and easy. An option to retrieve older images stored previously on the IMPAX system is also available. The result is shorter examination times for patients and, ultimately, less discomfort.

## Consistently correct X-ray settings

The full integration of the DX-D 100<sup>+</sup> system's generator via the NX acquisition workstation makes specifying the appropriate exposure technique for your study simple. Once an examination is selected on the NX workstation, the X-ray settings are automatically transmitted to the generator and displayed on the generator interface, where they can be changed easily if needed. After the exposure, the X-ray settings used are sent to the NX workstation and linked to the image for archiving.

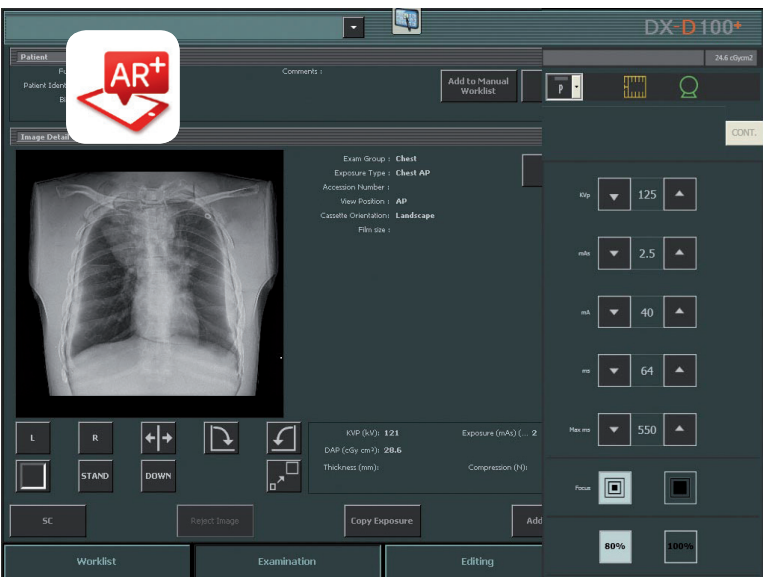

Generator settings are displayed on the monitor and can be adapted on the spot.

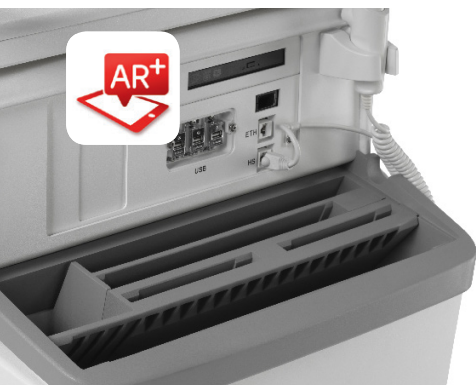

DX-D 100+: Wireless - Mobile - Maneuverable - Motorized

Fast and

# efficient

image transfer and access

Fast access to images via WiFi (where supported); information transfer with the touch of a finger; a solution built on the proven technologies of Agfa – the DX-D 100<sup>+</sup> maximizes the benefits of technology.

## Simple wireless image transfer and network printing

With the DX-D 100<sup>+</sup>, image transfer and network printing is a simple and straightforward task. Images can be sent directly to your PACS, and/or imager quickly, in DICOM format, using either your WiFi connection or wired network capabilities.

## From the imaging and integration specialists

Imaging and integration are our core business. In choosing the DX-D 100<sup>+</sup>, you can be confident that it is built on the same proven technologies as all Agfa solutions. These solutions deliver high quality, leading edge equipment, excellent productivity, and competitive service and maintenance agreements. They come from an innovative vendor committed not simply to starting you on your digital journey, but to helping you progress on your digital path into the future.

## Services & Support

Agfa offers service agreement solutions tailored to the individual customer's situation. The service agreements are available in Basic, Comfort and Advanced levels, making lifecycle costs predictable.

A worldwide team of some 1000 service professionals is at your disposal to provide support at all phases of your project. As an additional service, they can help you customize your examination tree or link RIS protocol codes for an even higher return on investment. Furthermore, this team carries out tasks that go well beyond maintenance, including value-added services such as super user training, staff training and software upgrades.

## Maximum technological benefits from the wireless DX-D 100<sup>+</sup> system

- **DR detectors:** instant previews and leading-edge technology
- **NX acquisition workstation:** very fast acquisition, excellent connectivity with RIS/PACS, and intuitive user interface
- **MUSICA imaging software:** the reference in maximizing contrast detail
- **X-ray equipment:** reliable heavy duty system, handles demanding workflows



Fast image capture at patient's bedside. The system incorporates the fully integrated NX acquisition workstation touch screen.

Make sure hands and the touch screen are dry before utilizing the touch screen. Excess moisture may affect the behavior of the capacitive touch screen. The operator always should verify the selected parameters and settings before making an exposure.

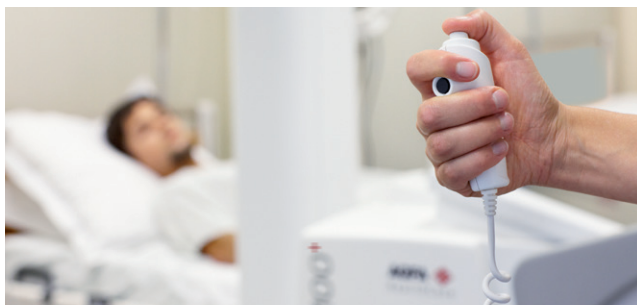

Remote control and handheld switches allow you to remain close to your patient during image capture.

DX-D 100<sup>+</sup>: Wireless - Mobile - Maneuverable - Motorized

For more information on Agfa, please visit our website on [www.agfa.com](http://www.agfa.com) ■

## A complete **DR portfolio** ■ ■ ■ empowered by **MUSICA**

From mobile to flexible C-arm, affordable floor-mounted or fully automated high-performance ceiling suspended DR rooms



Experience the possibilities of **Augmented Reality (AR)**, with the Agfa AR+ app. The app allows you to access AR, enriching a wide range of objects. The simple AR mechanism overlays or attaches virtual content to a physical object such as a page of a book or magazine, a painting, a billboard, a packaging, a sign, etc., allowing it to be experienced with an extra dimension using mobile devices or smart eyewear.

Whenever you see the Agfa AR+ pictogram in this brochure, simply launch the app and point the camera of your smartphone, tablet or glasses at the pictogram. Instantly, additional content becomes available – ranging from a simple video or animation to highly interactive, context specific content.

**Download the Agfa AR+ app via these links:**

<https://play.google.com/store/apps/details?id=com.agfa.agfaarplus&hl=nl>

<https://itunes.apple.com/us/artist/agfa-corporation/id448806868>

Agfa and the Agfa rhombus are trademarks of Agfa-Gevaert NV, Belgium, or its affiliates. DX-D, IMPAX, NX and MUSICA are trademarks of Agfa-Gevaert NV, Belgium, or its affiliates. All rights reserved. All information contained herein is intended for guidance purposes only, and characteristics of the products and services described in this publication can be changed at any time without notice. Products and services may not be available for your local area. Please contact your local sales representative for availability information. Agfa-Gevaert NV diligently strives to provide as accurate information as possible, but shall not be responsible for any typographical error.

© 2018 Agfa NV  
All rights reserved  
Published by Agfa NV  
Septestraat 27 - 2640 Mortsel  
Belgium

56NU7 GB 00201802